

* Extract from a Wilmot Breeden Publication produced in conjunction with the B.M.C.

B.M.C. SERVICE SCHOOL

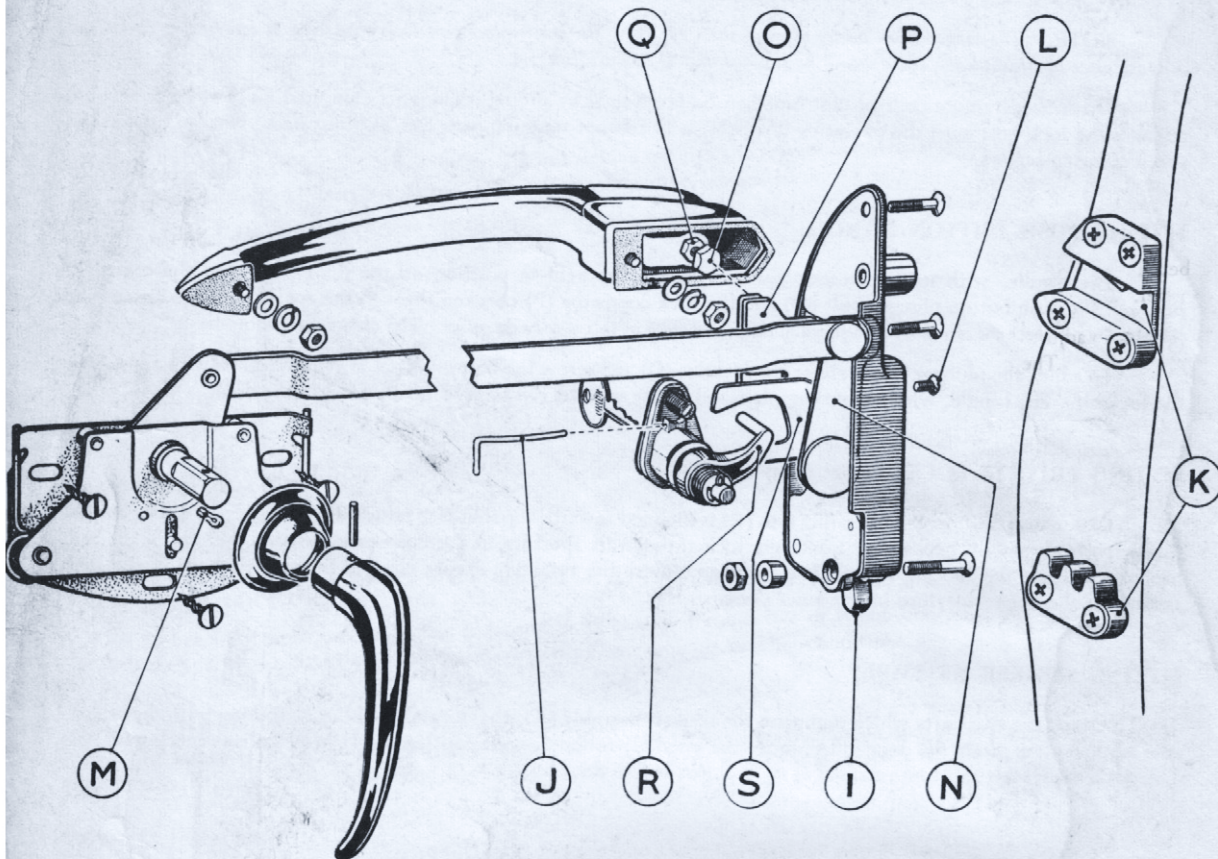

WILMOT BREEDEN DOOR FITTINGS

FOR _____ AUSTIN LANCER

WOLSELEY-15/60

M.G. MAGNETTE
ETC.

FITTING LOCK MECHANISM

Remote controls must be fitted in the locked position. In the case of front doors the remote control is supplied pegged in the locked position as illustrated at (M) ready for fitting.

SECURING THE LOCK AND REMOTE CONTROL ASSEMBLY

The lock and remote control units are 'plant-on' fitting and at this stage should be loosely screwed to the door. The three lock securing screws should be tightened first.

NOTE. The longer screw passes through the rotor (I). On new replacement locks this screw is retained by a nut and distance piece as illustrated. These should be removed and discarded.

The locked remote control unit can then be positioned by sliding it along its elongated holes as far as possible towards the lock unit until the operating lever (N) is in contact with the lock case as illustrated. Finally, tighten the three securing screws.

FITTING PUSH BUTTON HANDLE

The handle, with its two seating washers, should be held in position on the door panel and the clearance between the push button plunger bolt (O) and the lock contactor (P) checked through the aperture in the inner door panel. *Do not check the clearance by depressing the push button as this may be deceptive.* The clearance should be $\frac{1}{32}$ ".

To adjust the plunger bolt, release the locknut (Q) and screw the bolt in or out as required, finally re-tightening the locknut. The handle, with its seating, plain and spring washers can then be finally fixed to the door.

FITTING PRIVATE LOCK (Front doors only)

Check that the cranked operating arm (R) is inclined towards the shut face; it is spring-loaded and can be turned through 180 degrees if necessary. Insert the lock through its aperture in the door panel so that the end of the arm projects through the locking frame plate (S) then, insert the retaining spring clip (J) through its hole in the lock casting via the upper aperture in the inner door panel

FITTING STRIKER ASSEMBLY

Attach the two parts which comprise the striker assembly (K), the dovetail and the rack, loosely to the adjustable tapping plate inside the door pillar, move the assembly to the desired position and tighten the six securing screws. The striker assembly must be retained at right angles to the door hinges.

MASTER CHECK FOR CORRECT ALIGNMENT

Fit an inside handle on the window regulator spindle and wind the glass down, then fit a handle on the remote control spindle, inclined vertically downwards.

FRONT DOORS ONLY

Close the door then turn the inside handle forward into the locked position. It will automatically return to the central position when released. The door will then be locked.

Unlock the door from outside by turning the key *towards* the shut face. After turning, the key will automatically return to the vertical position when it can be removed

CHILDREN'S SAFETY CATCH OPERATION

The catch (P) is pre-set by moving the small lever, which projects from the lock case, *upwards*. This action prevents the inside handle from being operated to open the door although it can still be moved in the opposite direction to lock it.

Open the door from outside by depressing the push button.

LUBRICATION

Before fitting the door casing and other items ensure that any moving parts are adequately greased.

After assembly, introduce a few drops of thin machine oil into the private key slots and the oil hole (Q) which is revealed when the latch cam is rotated. These items should be lubricated once a month.

IMPORTANT :—*The private lock cylinders must not under any circumstances be lubricated with grease.*

FEATURES OF LOCK OPERATION

FREE PUSH BUTTONS

When doors are locked the push buttons may be freely depressed. No amount of wilful pressure on the outside push button will force or damage the lock.

TWO DOOR LOCKING

Either front door can be locked from inside or outside irrespective of which door was last used as an exit. This feature is invaluable in cases of traffic congestion and difficult parking conditions.

SELF CANCELLING

If either front door is closed after accidentally setting the inside handle in the locked position, locking is automatically cancelled. This action obviates the risk of locking oneself out of the car.

KEYLESS LOCKING

However, front doors can be locked from *outside* without using the key, a great advantage in inclement weather or under heavy traffic conditions where instant locking is desirable. This is achieved by setting the inside handle in the locked position and while closing the door *deliberately* holding the push button in the fully depressed position. The key must then be used for unlocking either front door in the usual way.

CHILDREN'S SAFETY CATCH

This is incorporated in all four door locks to cater for left and right hand drive models. In service, however, only the three passenger doors are used.

The catch (P) is pre-set by moving the small lever, which projects from the lock case, *upwards* before closing the door.

This action restricts the movement of the inside handle thus preventing it from being moved to open the door, although it can still be moved in the opposite direction to lock the door.

While the safety catch is in use the door can only be opened from outside.

NOTE : *On early production the rear door safety catch could only be pre-set while the inside handle was in the normal position and all inside handles were immovable while the safety catch was in operation.*